



SURGE SUPPRESSOR,  
SUPPRESSION DIODE WITH LED,  
DC 24...70V,  
F. CONT. RELAYS A. MOTOR CONT. SZ S00,

### General technical data:

product brand name		SIRIUS
product designation		surge suppressor
Size of the contactor		S00
Design of the surge suppressor		with diode
Ambient temperature		
• during storage	°C	-40 ... +80
• during operating	°C	-25 ... +60

### Control circuit:

Type of voltage / of the controlled supply voltage		DC
Control supply voltage / 1		
• for DC		
• initial rated value	V	24
• final rated value	V	70

### Installation/mounting/dimensions:

mounting position		any
Type of mounting		clip-on
Width	mm	28
Height	mm	46

Depth	mm	9
-------	----	---

#### Certificates/approvals:

##### Verification of suitability

CE / UL / CSA / CCC

##### General Product Approval

##### Declaration of Conformity

##### Test Certificates



CSA



GOST



UL



EG-Konf.

[Special Test Certificate](#)

##### Shipping Approval



ABS



BUREAU  
VERITAS



DNV



GL



LRS



PRS

##### Shipping Approval

##### other



RINA



RMRS

[Confirmation](#)



VDE

#### Further information:

##### Information- and Downloadcenter (Catalogs, Brochures,...)

<http://www.siemens.com/industrial-controls/catalogs>

##### Industry Mall (Online ordering system)

<http://www.siemens.com/industrial-controls/mall>

##### CAX-Online-Generator

<http://www.siemens.com/cax>

##### Service&Support (Manuals, Certificates, Characteristics, FAQs,...)

<http://support.automation.siemens.com/WW/view/en/3RT2916-1LM00/all>

##### Image database (product images, 2D dimension drawings, 3D models, device circuit diagrams, ...)

[http://www.automation.siemens.com/bilddb/cax\\_en.aspx?mlfb=3RT2916-1LM00](http://www.automation.siemens.com/bilddb/cax_en.aspx?mlfb=3RT2916-1LM00)

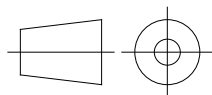
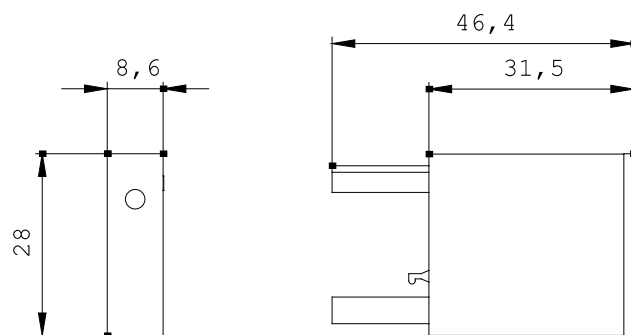

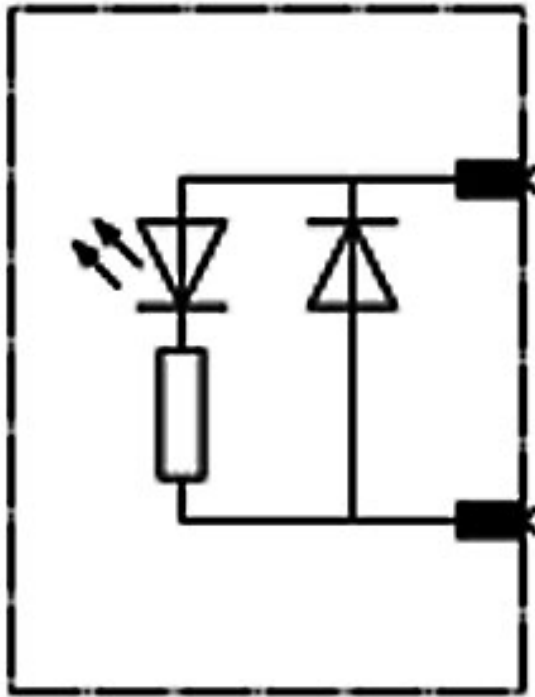

last change:

Apr 5, 2013